

# More than Senior Care. It's a Community.

Supporting an Exciting New Vision for Story Medical Senior Care



***Story  
Medical***  
*Senior Care*





## Dining Commons

**S**ince 1969, Story Medical Senior Care has been committed to providing quality care for its residents in a supportive and caring atmosphere. **Senior Care provides 24-hour care while offering a lifestyle that encourages independence, comfort and security, meets individual needs and encourages personal choice.**

As Story County Medical Center prepares to care for an aging population, we recognize our current Senior Care facility lacks a “home-like” feeling and an environment that optimizes healing. It is no longer a facility that meets the needs of our residents.

### WHY IS IT IMPORTANT?

Story County Medical Center is committed to caring for senior residents and supporting the

communities we serve. Providing high quality, compassionate long term care is an integral part of our enduring legacy. The current Senior Care facility is older, does not provide individual resident rooms, and has an inefficient layout. **This new facility will provide convenient care coordination for residents, provide individual rooms, and provide a space that looks like, and feels more like home.**

The new 59,000-square-foot facility located on the south campus of Story County Medical Center includes:

- **60 spacious, private rooms**
- **Memory care support**
- **Home-like, inviting porch entries**
- **Family gathering spaces**
- **Enclosed gardens for each Household**
- **Therapy room**

---

**“Our new facility will provide convenient care coordination for residents, individual rooms, and a space that looks like, and feels more like home.”**

Nate Thompson, CEO

# Providing a space that looks and feels more like home than a sterile healthcare facility will change how the resident's world looks in every way."

Ashley Wilson, Director of Nursing at Senior Care

The new Senior Care facility will enhance overall efficiency of Story County Medical Center by combining Nevada operations onto one campus, allowing for shared services to be easily leveraged to support Senior Care, hospital and clinics.

One of the key advantages of constructing a new Senior Care facility on the Story County Medical Center campus is the enhancement it brings to the resident and family experiences through a state-of-the-art "household" model. This innovative model creates an environment that resembles a true home, providing residents with a sense of comfort, familiarity, and belonging.

Additionally, staff will benefit from a facility designed to support their workflow, enabling them to provide

the highest standard of care and forge deeper connections with residents. **Through this project, we strive to set a new standard for senior care, ensuring residents thrive and experience the utmost comfort and well-being.**

## WHEN WILL IT OPEN?





Construction on the new Senior Care facility began in April 2023 and is estimated to open to residents in late 2024.

## HOW CAN I SUPPORT THE PROJECT?

You can make a gift in support of the new Senior Care facility to the Story County Medical Center Endowment Foundation. **All gifts of \$1,000 or more will be recognized on a special donor wall located inside Senior Care.**

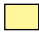
# Story Medical Senior Care Donor Recognition Opportunities

We invite you to invest in the Story County Medical Center Senior Care Capital Campaign. As an investor, you will have the opportunity to name a designated area of the facility. The available areas offer visible recognition of your support for Senior Care and its residents. Please join us in creating a facility for the future.

NAMING AREA	GIFT AMOUNT	AVAILABLE
 Household . . . . .	\$150,000.....	3
 Household Courtyard . . . . .	\$100,000.....	3
 Dining Commons . . . . .	\$50,000.....	3
 Multipurpose Room . . . . .	\$25,000.....	1
 Physical Therapy Room . . . . .	\$25,000.....	1

All gifts of \$1,000 or more will be recognized on a special donor wall located inside the Senior Care facility.  
 \*Naming of any areas shall be in accordance with Story Medical's Policy for Naming of Facilities (available upon request).

# A Closer Look



A bird's eye view offers a look at the layout of the new Senior Care complex. The facility will be located adjacent to the Story Medical South Campus.



The new Story Medical Senior Care offers a more home-like, residential design and includes conveniences like a covered dropoff area at the main entrance.



For information on making a gift in support of the new Story Medical Senior Care, please contact Liz Zuercher by email at [lzuercher@storymedical.org](mailto:lzuercher@storymedical.org) or call (515) 382-7728. **Thank you for your consideration!**

# Features of the New Story Medical Senior Care

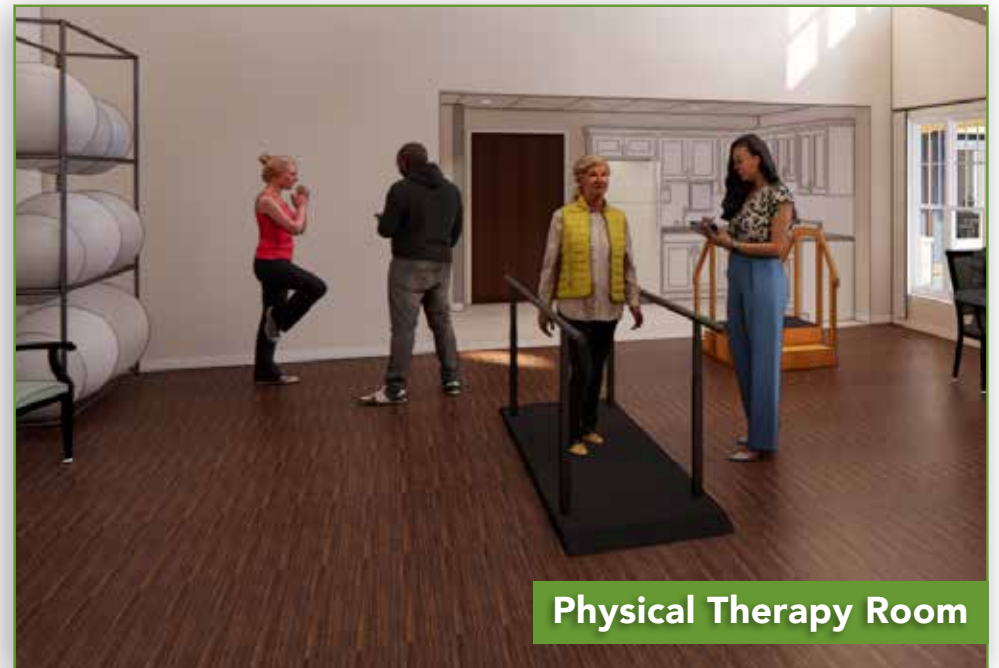

# Story Medical Senior Care: A Closer Look

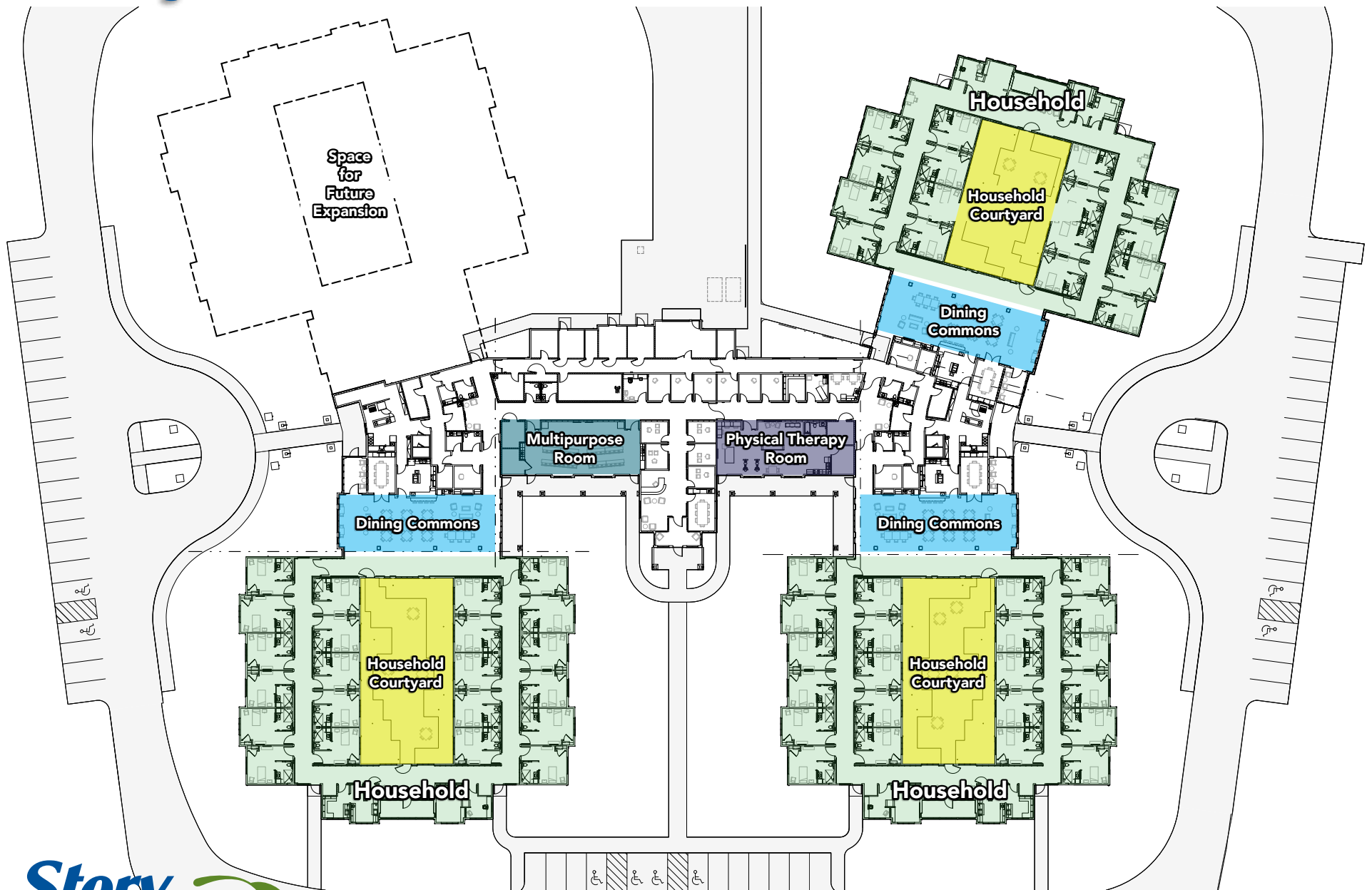

**It's More than Senior Care. It's a Community.**